

basically trade®

Trade Carcass Brochure





## Contents

### Kitchen Carcasses

---

● Hiline Base Units	10
● Drawerline Base Units	11 - 12
● Drawer Base Units	14
● Low Level Base Units	14
● Oven and Microwave Base Units	15
● Belfast Sink Base Units	16
● Base Open Units	16
● Base Tall Open Units	16
● Small Wall Units (575 high)	17
● Medium Wall Units (720 high)	19
● Tall Wall Units (900 high)	20
● Top Boxes	21
● Small Dressers (1065 high)	21
● Medium Dressers (1210 high)	22
● Tall Dressers (1390 high)	22
● Fridge / Freezer Housings	23
● Oven Housings	24 - 25
● Miscellaneous Tall Units	25
● Accessory Panels	27

### Bedroom Carcasses

---

● Wardrobes	30
● Internal Accessories	31
● External Accessories	31
● Top Boxes	32
● Bedside Height Base Units	34
● Bedside Height Drawer Chests	34
● Standard Height Base Units	35
● Standard Height Drawerline Base Units	37
● Standard Height Drawer Chests	37
● Tall Drawer Chests	38
● Miscellaneous	38
● Accessory Drawers	38
● Accessory Panels	40



basically trade®

bespoke kitchens, bedrooms & doors

## CUSTOM-MADE CARCASSES

Bespoke carcass units produced for kitchens, bedrooms, offices and more.

We can make units for your specific requirements, no matter how unusual they may be.

We are also a trade supplier of complete kitchens and bedrooms.



# MADE FOR THE TRADE

Welcome to Basically Trade.

Basically Trade is a friendly, family-run manufacturer of kitchens, bedrooms, doors and more, based in Padiham, Lancashire.

As you may already know, we have been servicing this industry for more than 20 years and we're very proud of every product we provide – from well-designed doors to complete kitchens and bespoke bedrooms.

You may not be aware, however, that we also manufacture our very own high quality carcass range, right here in the UK!

Our cabinets and carcasses can be designed to your exact specification to ensure that your clients benefit from beautifully bespoke results, every time.

However awkward the dimensions may be, our kitchen and bedroom carcasses are designed and built with passion and precision.

Whether you're a joiner, builder, architect, kitchen or bedroom fitter – we can provide a made-to-measure solution to suit.

Proud to be  
a member of



In an effort to 'do our bit' for the natural environment around us, the Basically Trade team insist on using only sustainably sourced timber.

Our quality control systems are second to none, which contributes to the sterling reputation we are proud to uphold. Quality and customer satisfaction are the cornerstones of our business, so we work closely with clients to provide the perfect product for every individual project.

If you're looking for a complete solution, you'll find that we have all the complementary doors and accessories to make sure your project has a perfectly polished finish, inside and out.

We're happy to advise on even the trickiest projects, with no obligation. So please feel free to give us a call to discuss your next contract, or take a look at our website to view case studies of some of the more unusual projects we've worked on.





basically trade®

bespoke kitchens, bedrooms & doors





## Colour-matched **KITCHEN CARCASSES**

Basically Trade offers both made-to-measure and standard-sized kitchen carcasses made on site, right here in Lancashire.

Cabinets can be colour coded to match the chosen doors and plinths, along with 2mm PVC edging tapes, so your project has a perfect finish throughout.

Unless otherwise specified, we use Blum fittings as standard, which come with a lifetime guarantee.

To save valuable time when it comes to installation, we can supply drawer and wall units fully assembled using rigid cam and dowel construction. Base units have adjustable height legs, and wall units are fitted with adjustable brackets.

Blum drawer boxes are used as standard and dovetailed solid timber drawers are also available, in timbers such as Oak, Walnut, Beech, Maple and Birch Plywood.

We refuse to compromise on quality, here at Basically Trade!



\* Prices on quotation basis



## Hiline Base Units (870 high inc legs)



FULL HEIGHT BASE UNIT

Code: **KHB15 - KHB6**

Width (mm): 150 - 600



DOUBLE FULL HEIGHT BASE UNIT

Code: **KHB6T - KHB12**

Width (mm): 600 - 1200



FULL HEIGHT 900 CORNER L-SHAPE BASE UNIT  
330 x 330 front cut outs  
4 x 170 degree hinges

Code: **KHLCB**

Width (mm): 900 x 900



FULL HEIGHT CORNER BASE UNIT WITH BLANKING PANEL

Code: **KHCB83 - KHCB116**

Width (mm): 800 - 1100



FULL HEIGHT CORNER BASE UNIT WITH BLANKING PANEL  
*To take a pair of doors*

Code: **KHCBT116 - KHCBT1512**

Width (mm): 1100 - 1500

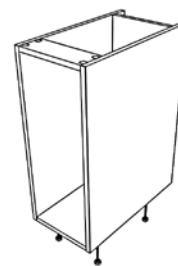

BASE UNIT TRAY SPACE  
*Please state size when ordering*

Code: **KTS3**

Width (mm): up to 300

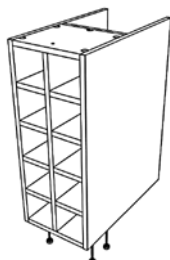

BASE WINE RACK WITH LEGS

Code: **KBWR15 - KBWR5**

Width (mm): 150 / 300 / 500

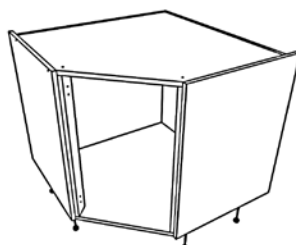

CORNER DIAGONAL BASE UNIT  
*To take a 450 door*

Code: **KDHCB**

Width (mm): 900 x 900

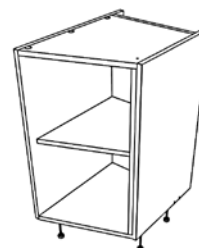

SPLAYED ANGLE BASE UNIT

Code: **KAHB3 - KAHB4**

Width (mm): 300 - 400



## Drawerline Base Units (870 high inc legs)



**BASE DRAWERLINE UNIT**  
To take one door and one drawer

Code: **KDB3 - KDB6**

Width (mm): 300 - 600



**BASE DRAWERLINE UNIT**  
To take two doors and two drawers

Code: **KDBT6 - KDB12**

Width (mm): 600 - 1200



**DRAWERLINE L-SHAPE  
BASE UNIT**  
To take two doors & dummy  
drawers strapped together

Code: **KDLCB**

Width (mm): 900 X 900



**DRAWERLINE CORNER BASE UNIT**  
With blanking panel to take one door  
and one drawer

Code: **KDCB83 - KDCB116**

Width (mm): 800 - 1100



**DRAWERLINE CORNER  
BASE UNIT**  
With blanking panel to take one door  
and one dummy drawer.

Code: **KDDCB104 - KDDCB116**

Width (mm): 1000 x 1100



**DRAWERLINE CORNER  
BASE UNIT**  
With blanking panel to take two  
doors and two drawers

Code: **KDCBT116 - DCBT1512**

Width (mm): 1100 x 1500

## Drawerline Base Units (870 high inc legs)



### DRAWERLINE SINK BASE UNIT

*To take one door and one dummy drawer*

Code: **KDSB5 - KDSB6**

Width (mm): 500 - 600



### DRAWERLINE SINK BASE UNIT

*To take two doors and two dummy drawers*

Code: **KDSB7 - DSB12**

Width (mm): 700 - 1200



### DRAWERLINE CORNER BASE UNIT

*To take dummy drawer or working drawer with door*

Code: **K1DSB8 - K1DSB12**

Width (mm): 800 - 1200

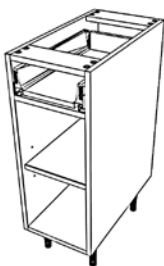

### PENINSULAR BASE UNIT

*Working drawer(s) on one side only*

Code: **KPDB3 - KPDB12**

Width (mm): 300 - 1200



### CORNER DIAGONAL BASE UNIT

*To take a 450 door and dummy drawer strapped together*

Code: **KDDCB**

Width (mm): 900 x 900



### OPEN DRAWERLINE BASE UNIT

*For wicker baskets*

Code: **KODB5 - KODB6**

Width (mm): 500 - 600



### ANGLED BASE UNIT

*To take a door and dummy drawer strapped together*

Code: **KADB3 - KADB4**

Width (mm): 300 - 400



## Drawer Base Units (870 high inc legs)



5 DRAWER BASE UNIT  
5 x 140 drawers

Code: **K5DP3 - K5DP6**

Width (mm): 300 - 600



4 DRAWER BASE UNIT  
4 x 175 drawers

Code: **K4DP3 - 4DP6**

Width (mm): 300 - 600



3 DRAWER BASE UNIT  
1 x 140 drawer, 2 x 283 drawers

Code: **K3PD4 - K3PD10**

Width (mm): 400 - 1000



2 DRAWER BASE UNIT  
2 x 355 drawers

Code: **K2PD4 - K2PD10**

Width (mm): 400 - 1000



4 DRAWER BASE UNIT  
3 x 140 drawers, 1 x 283 drawer

Code: **K4PD4 - K4PD10**

Width (mm): 400 - 1000

## Low Level Base Units (725 high inc legs)



LOW LEVEL BASE UNIT

Code: **KLHB3 - KLHB6**

Width (mm): 300 - 600

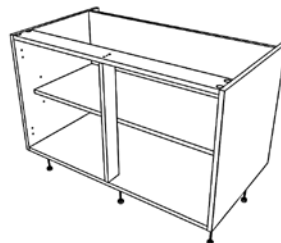

LOW LEVEL DOUBLE BASE UNIT

Code: **KLHB7 - KLHB12**

Width (mm): 700 - 1200

Oven and Microwave Base Units (870 high inc legs)

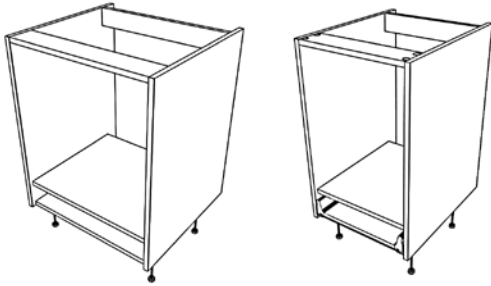

**BUILT UNDER OVEN HOUSING**  
Fixed fascia / working drawer

Code: **KBON1 / KBON2**

Width (mm): 600

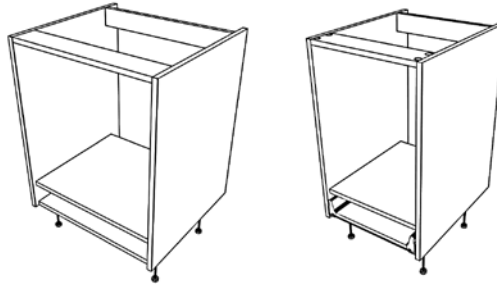

**BUILT UNDER OVEN HOUSING**  
Fixed fascia / working drawer

Code: **KBON3 / KBON4**

Width (mm): 900



**CONTINENTAL OVEN HOUSING**  
Door  
Height: 885

Code: **KCOH1**

Width (mm): 600

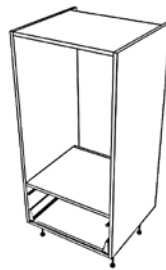

**CONTINENTAL OVEN HOUSING**  
Working drawer  
Height: 1185

Code: **KCOH9**

Width (mm): 600



**CONTINENTAL OVEN HOUSING**  
Working drawers  
Height: 1475

Code: **KCOH10**

Width (mm): 600



**BUILT UNDER MICROWAVE HOUSING** 283 drawer / 355 drawer

Code: **KBMN1 / KBMN2**

Width (mm): 600

## Belfast Sink Base Units (height as specified)

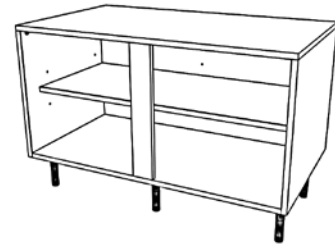

**BELFAST SINK BASE UNIT**  
With full MFC top - 650 high (inc legs)

Code: **KBB6 - KBB9**

Width (mm): 600 / 900

**BELFAST SINK BASE UNIT**  
With full MFC top - 500 high (inc legs)

Code: **KTBB6 - KTBB9**

Width (mm): 600 / 900

## Base Open Units (870 high inc legs)

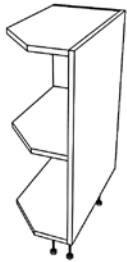

**BASE OPEN END UNIT**

Code: **KBES**

Width (mm): 300

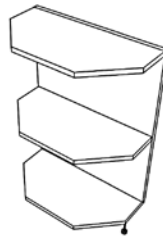

**BASE OPEN PENINSULAR UNIT**

Code: **KPES**

Width (mm): 300

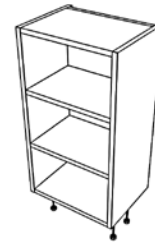

**BASE OPEN SHELF UNIT**  
300 deep

Code: **KOHB15 - KOHB6**

Width (mm): 150 - 600

## Base Tall Open Units (height as specified)



**OPEN END UNIT**

To suit low wall units, 1970 high (inc legs)

Code: **KSES**

Width (mm): 300



**OPEN END UNIT**

To suit med wall units, 2120 high (inc legs)

Code: **KMES**

Width (mm): 300



**OPEN END UNIT**

To suit tall wall units, 2300 high (inc legs)

Code: **KTES**

Width (mm): 300

## Small Wall Units (575 high)

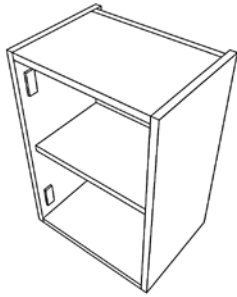

SMALL WALL UNIT  
Single

Code: **KSW3 - KSW6**

Width (mm): 300 - 600

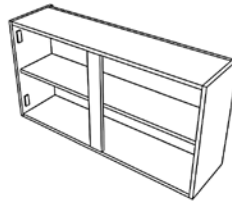

SMALL WALL UNIT  
Double doors

Code: **KSW6T - KSW12**

Width (mm): 600 - 1200

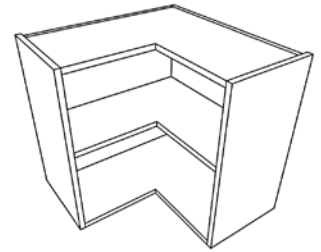

SMALL L-SHAPE CORNER WALL UNIT 300 x 300 opening for fascias

Code: **KSLCW**

Width (mm): 600 x 600



SMALL ANGLED CORNER WALL UNIT

Code: **KSACW**

Width (mm): 600 x 600

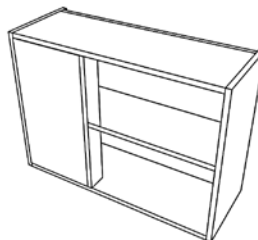

SMALL STANDARD CORNER WALL UNIT with a 300 blanking panel

Code: **KSCW63 - KSCW96**

Width (mm): 600 - 900

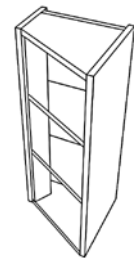

ANGLED SMALL WALL UNIT

Code: **KASW3 - KASW4**

Width (mm): 300 - 400

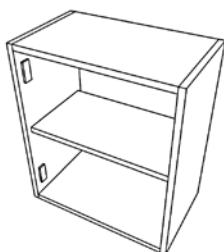

SMALL PENINSULAR WALL UNIT

Code: **KPSW3 - KPSW6**

Width (mm): 300 - 600

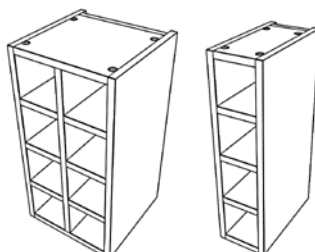

SMALL WINE RACK  
300 deep

Code: **KSWR15 - KSWR3**

Width (mm): 150 / 300

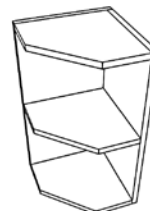

SMALL WALL END SHELF

Code: **KSWES**

Width (mm): 300

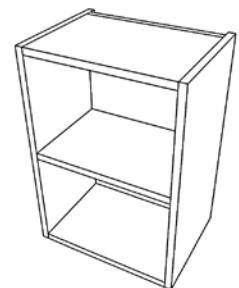

SMALL WALL OPEN SHELF UNIT

Code: **KOSW3 - KOSW10**

Width (mm): 300 - 1000





## Medium Wall Units (720 high)



MEDIUM WALL UNIT

Single

Code: **KMW3 - KMW6**

Width (mm): 300 - 600



MEDIUM WALL UNIT

Double doors

Code: **KMW6T - KMW12**

Width (mm): 600 - 1200

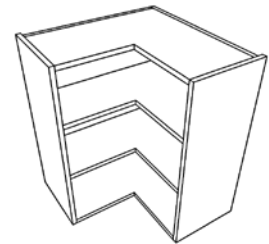

MEDIUM L-SHAPED CORNER WALL UNIT 300 x 300 opening for fascias

Code: **KMLCW**

Width (mm): 600 x 600

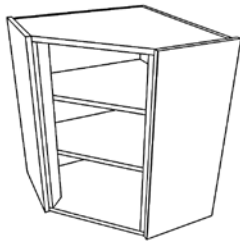

MEDIUM ANGLED CORNER WALL UNIT

Code: **KMACW**

Width (mm): 600 x 600



MEDIUM STANDARD CORNER WALL UNIT with a 300 blanking panel

Code: **KMCW63 - KMCW96**

Width (mm): 600 - 900

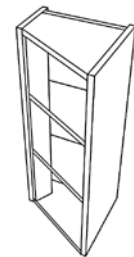

ANGLED MEDIUM WALL UNIT

Code: **KAMW3 - KAMW4**

Width (mm): 300 - 400



MEDIUM PENINSULAR WALL UNIT

Code: **KPMW3 - KPMW6**

Width (mm): 300 - 600

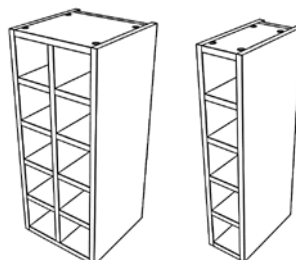

MEDIUM WINE RACK 300 deep

Code: **KMWR15 - KMWR3**

Width (mm): 150 - 300

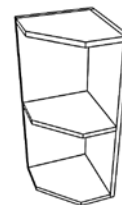

MEDIUM WALL END SHELF

Code: **KMWES**

Width (mm): 300



MEDIUM WALL OPEN SHELF UNIT

Code: **KOMW3 - KOMW10**

Width (mm): 300 - 1000

## Tall Wall Units (900 high)



TALL WALL UNIT  
Single

Code: **KTW3 - KTW6**

Width (mm): 300 - 600



TALL WALL UNIT  
Double doors

Code: **KTW6T - TW12**

Width (mm): 600 - 1200

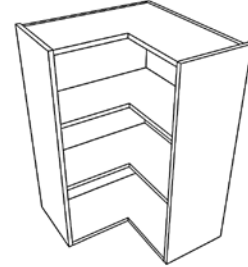

TALL L-SHAPED CORNER WALL UNIT  
300 x 300 opening for fascias

Code: **KTLCW**

Width (mm): 600 x 600



TALL ANGLED CORNER  
WALL UNIT

Code: **KTACW**

Width (mm): 600 x 600



TALL STANDARD CORNER  
WALL UNIT with a 300 blanking panel

Code: **KTCW63 - KTCW96**

Width (mm): 600 - 900

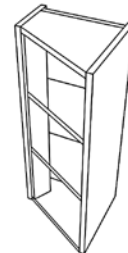

ANGLED TALL  
WALL UNIT

Code: **KATW3 - KATW4**

Width (mm): 300 - 400



TALL PENINSULAR  
WALL UNIT

Code: **KPTW3 - KPTW6**

Width (mm): 300 - 600

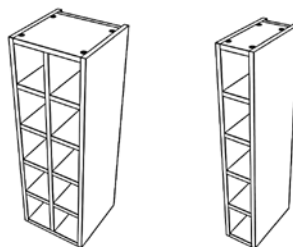

TALL WINE RACK  
300 deep

Code: **KTWR15 - KTWR3**

Width (mm): 150 / 300



TALL WALL  
END SHELF

Code: **KTWES**

Width (mm): 300

## Top Boxes (height as specified)

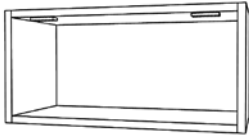

**SMALL SINGLE TOP BOX**  
288 high

Code: **KSTB4 - KSTB6**

Width (mm): 400 - 600

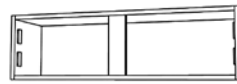

**SMALL DOUBLE TOP BOX**  
288 high

Code: **KSTB8 - KSTB12**

Width (mm): 800 - 1200

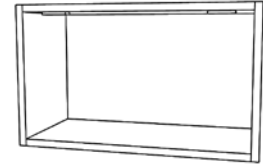

**MEDIUM SINGLE TOP BOX**  
360 high

Code: **KMTB4 - KMTB8**

Width (mm): 400 - 600

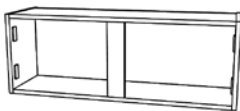

**MEDIUM DOUBLE TOP BOX**  
360 high

Code: **KMTB10 - KMTB12**

Width (mm): 800 - 1200

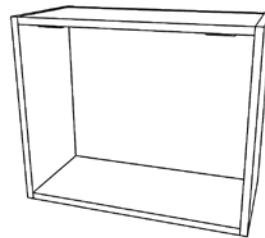

**TALL SINGLE TOP BOX**  
495 high

Code: **KTTB5 - KTTB6**

Width (mm): 400 - 600

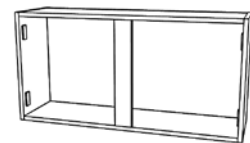

**TALL DOUBLE TOP BOX**  
495 high

Code: **KTTB8 - KTTB12**

Width (mm): 800 - 1200

## Small Dressers (1065 high)



**DRESSER**  
1065 high to take 1060 door

Code: **KSD5 - KSD6**

Width (mm): 500 - 600



**DRESSER** to take 895 door,  
160 drawer

Code: **KSD51 - KSD61**

Width (mm): 500 - 600



**DRESSER** to take 715 door,  
140 drawer, 195 drawer

Code: **KSD52 - KSD62**

Width (mm): 500 - 600

## Medium Dressers (1210 high)



DRESSER To take 1205 door

Code: **KMD5 - KMD6**

Width (mm): 500 - 600



DRESSER To take 1060 door,  
140 drawer

Code: **KMD51 - KMD61**

Width (mm): 500 - 600



DRESSER To take 915 door,  
2 x 140 drawers

Code: **KMD52 - KMD62**

Width (mm): 500 - 600

## Tall Dressers (1390 high)



DRESSER To take 1060 door,  
140 drawer, 175 drawer

Code: **KTD52 - KTD62**

Width (mm): 500 - 600



DRESSER To take 895 door,  
2 x 140 drawers, 1 x 195 drawer

Code: **KTD53 - KTD63**

Width (mm): 500 - 600

## Fridge / Freezer Housings (height 1970 – 2300)



**FRIDGE / FREEZER HOUSING**  
To take 2 x doors 1800 appliance aperture

Code: **KSFH1, KMFH1, KTFH1, KTFH1B**

Width (mm): 600



**FRIDGE / FREEZER HOUSING**  
To take 2 x doors, 2 x 900 appliance apertures

Code: **KSFH2, KMFH2, KTFH2**

Width (mm): 600



**FRIDGE / FREEZER HOUSING**  
To take 3 x doors, 900 appliance aperture

Code: **KSFH3, KMFH3, KTFH3**

Width (mm): 600



**FRIDGE / FREEZER HOUSING**  
To take 2 x doors, 2 x drawers, 900 appliance aperture

Code: **KSFH4, KMFH4, KTFH4**

Width (mm): 600



**FRIDGE / FREEZER HOUSING**  
To take 2 x doors, 1 x drawer, 1245 appliance aperture

Code: **KSFH5, KMFH5, KTFH5**

Width (mm): 600

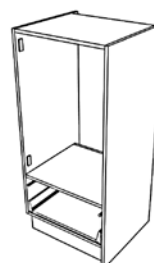

**CONTINENTAL FRIDGE / FREEZER HOUSING**  
To take 1 door, 1 drawer, 900 appliance

Code: **KCFH1 - KCFH2**

Width (mm): 600

## Oven Housings (1970 – 2300 high inc legs)



**SINGLE OVEN HOUSING**  
600 appliance. To take 2 doors

Code: **KSOH1, KMOH1, KTOH1**

Width (mm): 600



**SINGLE OVEN HOUSING**  
600 appliance. To take 1 door, 2 drawers

Code: **KSOH2, KMOH2, KTOH2**

Width (mm): 600



**SINGLE OVEN HOUSING**  
600 appliance. To take 2 doors, 1 drawer

Code: **KSOH3, KMOH3, KTOH3**

Width (mm): 600

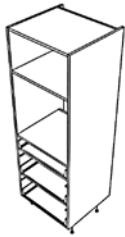

**SINGLE OVEN HOUSING**  
600 appliance. To take 1 door, 3 drawers

Code: **KSOH4, KMOH4, KTOH4**

Width (mm): 600



**CONTINENTAL DOUBLE OVEN HOUSING**  
900 appliance. To take 1 door  
Height 1035 - 1335

Code: **KCOH1 - KCOH4**

Width (mm): 600



**CONTINENTAL OVEN HOUSING**  
900 appliance. Height 1035 – 1335  
To take 2 drawers

Code: **KCOH5 - KCOH12**

Width (mm): 600

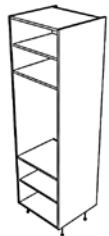

**DOUBLE OVEN HOUSING**  
900 appliance. To take 2 doors

Code: **KSOH5, KMOH5, KTOH5**

Width (mm): 600



**DOUBLE OVEN HOUSING**  
900 appliance. To take 1 door, 2 drawers

Code: **KSOH6, KMOH6, KTOH6**

Width (mm): 600

## Oven Housings (1970 – 2300 high inc legs)

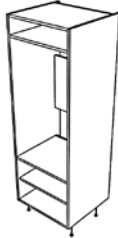

**SINGLE OVEN & MICROWAVE HOUSING** To take 2 doors

Code: **KSOH8, KMOH8, KTOH8**

Width (mm): 600

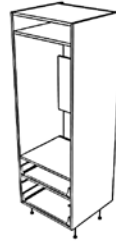

**SINGLE OVEN & MICROWAVE HOUSING** To take 1 door, 2 drawers

Code: **KSOH9, KMOH9, KTOH9**

Width (mm): 600

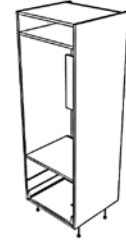

**SINGLE OVEN & MICROWAVE HOUSING** To take 1 door, 1 drawer

Code: **KSOH7, KMOH7, KTOH7**

Width (mm): 600

## Miscellaneous Tall Units (1970 – 2300 high inc legs)



**LARDER UNIT**

To take 2 doors

Code: **KSL3-6, KML3-6, KTL3-6**

Width (mm): 300 – 600



**BROOM UNIT**

To take 2 doors

Code: **KSB3-6, KMB3-6, KTB3-6**

Width (mm): 300 – 600



**WINE RACK**

Code: **SWR**

Width (mm): 150 / 300





## Accessory Panels



Chic Collection, London City apartment



PLINTH

Code: **KPMFC**

Width (mm): 2600 x 150



END PANEL

Code: **SWEP - XTEP**

Height (mm): 575 - 2600

Chic Collection kitchen, Wimbledon



BASE & WALL FILLER

100 wide

Code: **KF1 - KF7**

Height (mm): 575 - 2600



BASE & WALL FILLER

200 wide

Code: **KF8 - KF14**

Height (mm): 575 - 2600



SHOWBACK PANEL

900 high

Code: **KBP12 - KBP26**

Height (mm): 1200 - 2000



FLYOVER SHELF

Code: **KFO3 - KFO45**

Width (mm): 300 - 450



**basically trade**

bespoke kitchens, bedrooms & doors





## Beautifully bespoke **BEDROOM UNITS**

When it comes to bedroom carcasses, we can work with you to create the perfect wardrobe space for your customer. From full-length hanging space, to different-sized drawers - we'll help design the perfect fit.

As you'd expect, all cabinets are colour coded throughout to match the doors, and Blum fittings are used as standard.

To save time when it comes to installation, robes are supplied flat packed for easy manoeuvrability while drawer units and top boxes are provided fully assembled.

Basically Trade is committed to quality and all the units we manufacture are 18mm throughout, including backs and drawer bases!

For high end projects, we can offer clear-lacquered, solid timber dovetailed drawer boxes in timbers such as Birch Plywood, Oak, Walnut, Beech and Maple. What's more, we can even provide matching inserts for particularly discerning customers to organise socks, ties, jewellery and more.

*\* Prices on quotation basis*



## Wardrobes (2260 high)



**STANDARD SINGLE ROBE**  
1 hanger

Code: **BR3 - BR6**

Width (mm): 300 - 600



**STANDARD DOUBLE ROBE**  
1 hanger (shown as double hanging)

Code: **BR6T - BR12**

Width (mm): 600 - 1200

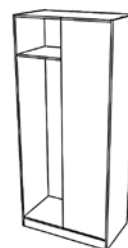

**STANDARD CORNER ROBE**  
Including 500 blanking panel

Code: **BCR35 - BCR6**

Width (mm): 850 - 1100



**SINGLE STABLE ROBE**

Code: **BSR5 - BSR6**

Width (mm): 500 - 600



**DOUBLE STABLE ROBE**

Code: **BSR9 - BSR10**

Width (mm): 900 - 1000



**CORNER DIAGONAL ROBE**  
1 curved hanger

Code: **BDR4 - BDR65**

Width (mm): Back width in both directions 870 - 1050

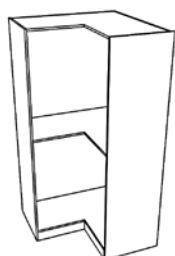

**L-SHAPE CORNER ROBE**  
Curved hanger (shown as double hanging)

Code: **BLCR3 - BLCR5**

Width (mm): back width 870 x 890,  
970 x 990, 1070 x 1090



**SINGLE COMBINATION LINEN ROBE** 1495 high doors, 3 x 215 drawers

Code: **BLR3 - BLR6**

Width (mm): 300 - 600

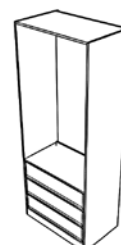

**DOUBLE COMBINATION LINEN ROBE** 1495 high doors, 3 x 215 drawers

Code: **BLR7 - BLR10**

Width (mm): 700 - 1000

## Internal Accessories



### SINGLE INTERNAL CHEST

Including MFC worktop

Code: **BIC4 - BIC6**

Width (mm): 400 - 600



### DOUBLE INTERNAL CHEST

Including MFC worktop

Code: **BIC7 - BIC10**

Width (mm): 700 - 1000

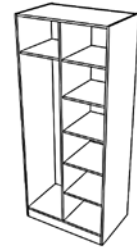

### INTERNAL ROBE PACK

1 divider, 5 shelves, 1 rail

Code: **BRP6 - BRP12**

Width (mm): 600 - 1200

## External Accessories



### RH / LH BASE END SHELF

760 high inc 100 plinth

Code: **BBESR3 / BBESL3**

Width (mm): 300



### RH / LH TALL END SHELF

2260 high inc 100 plinth

Code: **BTESR3 / BTESL3**

Width (mm): 300

# Bedroom Carcasses

## Top Boxes (height as stated)

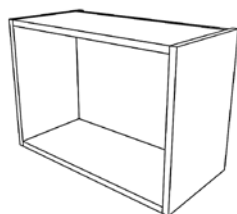

SINGLE TOP BOX

420 high, 415 high door

Code: **BBSTB3 - BBSTB6**

Width (mm): 300 - 600

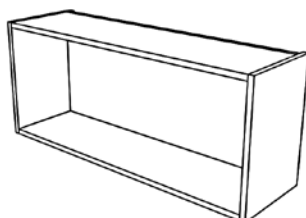

DOUBLE TOP BOX

420 high, 415 high door

Code: **BBSTB7 - BBSTB12**

Width (mm): 700 - 1200

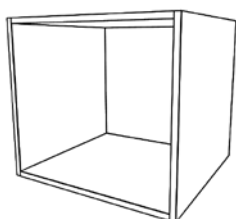

SINGLE TOP BOX

540 high, 535 high door

Code: **BBTTB3 - BBTTB6**

Width (mm): 300 - 600

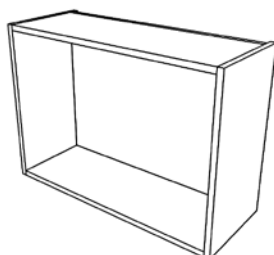

DOUBLE TOP BOX

540 high, 535 high door

Code: **BBTTB7 - BBTTB12**

Width (mm): 700 - 1200





## Bedside Height Base Units (640 high)



### BEDSIDE SINGLE CABINET

535 high door

Code: **BBC3 - BBC6**

Width (mm): 300 - 600



### BEDSIDE DOUBLE CABINET

535 high doors

Code: **BBC6T - BBC12**

Width (mm): 600 - 1200



### BEDSIDE SINGLE DRAWERLINE BASE UNIT

390 high door, 140 drawer

Code: **BBDB3B - BBDB6B**

Width (mm): 300 - 600



### BEDSIDE DOUBLE DRAWERLINE BASE UNIT

390 high doors, 140 drawers

Code: **BBDB6TB - BBDB10B**

Width (mm): 600 - 1000



### BEDSIDE SINGLE DRAWERLINE BASE UNIT

415 high door, 115 drawer

Code: **BBDB3 - BBDB6**

Width (mm): 300 - 600



### BEDSIDE DOUBLE DRAWERLINE BASE UNIT

415 high doors, 115 drawers

Code: **BDR4 - BDR65**

Width (mm): 600 - 1000

## Bedside Height Drawer Chests (640 high)



### BEDSIDE 3 DRAWER CHEST

3 x 175 drawers

Code: **BB3D3 - BB3D10**

Width (mm): 300 - 1000



### BEDSIDE 2 DRAWER CHEST

2 x 265 drawers

Code: **BB2D3 - BB2D10**

Width (mm): 300 - 1000



## Standard Height Base Units (760 high)



STANDARD HEIGHT  
SINGLE BASE UNIT  
655 high door

Code: **BSHB3 - BSHB6**

Width (mm): 300 - 600



STANDARD HEIGHT  
DOUBLE BASE UNIT  
655 high doors

Code: **BSHB6T - BSHB12**

Width (mm): 600 - 1200



STANDARD HEIGHT  
CORNER BASE UNIT  
655 high door including  
400 blanking panel

Code: **BSHCB35 - BSHCB6**

Width (mm): 750 - 1200

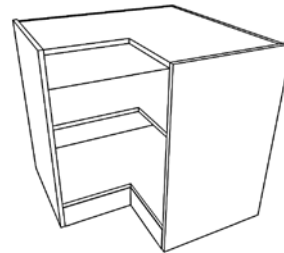

STANDARD HEIGHT L-SHAPE  
CORNER  
655 high doors

Code: **BSHLCB**

Width (mm): 770 x 790



PVC edged bedroom, Harrogate



PVC edged office, Aberdeen

## Standard Height Drawerline Base Units (760 high)



STANDARD HEIGHT SINGLE  
DRAWERLINE BASE UNIT  
510 high door, 140 drawer

Code: **BSDB3B - BSDB6B**

Width (mm): 300 - 600



STANDARD HEIGHT DOUBLE  
DRAWERLINE BASE UNIT  
510 high door, 140 drawer

Code: **BSDB6TB - BSDB10B**

Width (mm): 600 - 1000



STANDARD HEIGHT SINGLE  
DRAWERLINE BASE UNIT  
535 high door, 115 drawer

Code: **BSDB3 - BSDB6**

Width (mm): 300 - 600



STANDARD HEIGHT DOUBLE  
DRAWERLINE BASE UNIT  
535 high door, 115 drawer

Code: **BSDB6T - BSDB10**

Width (mm): 600 - 1000

## Standard Height Drawer Chests (760 high)



STANDARD HEIGHT  
3 DRAWER CHEST  
3 x 215 drawers

Code: **BS3D3 - BS3D10**

Width (mm): 300 - 1000

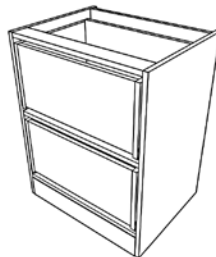

STANDARD HEIGHT  
2 DRAWER CHEST  
2 x 325 drawers

Code: **BS2D3 - BS2D10**

Width (mm): 300 - 1000

# Bedroom Carcasses

## Tall Drawer Chests (height as stated)



4 DRAWER CHEST  
980 high, 4 x 215 drawers

Code: **B4D3 - B4D10**

Width (mm): 300 - 1000



5 DRAWER CHEST  
1000 high, 5 x 175 drawers

Code: **B5D3 - B5D10**

Width (mm): 300 - 1000

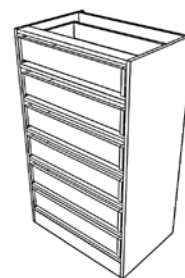

6 DRAWER CHEST  
1180 high, 6 x 175 drawers

Code: **B6D4 - B6D10**

Width (mm): 400 - 1000

## Miscellaneous



TV UNIT WITH 3 DRAWERS  
1360 high, 715 high doors,  
3 x 175 drawers

Code: **BTV8 - BTV10**

Width (mm): 800 - 1000

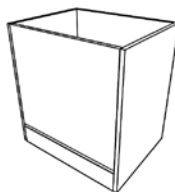

LAUNDRY CHEST  
760 high, 450 wide, 450 deep

Code: **BLC**

Width (mm): 450

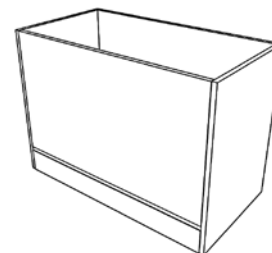

OTTOMAN  
640 high, 470 deep

Code: **BO3 - BO10**

Width (mm): 300 - 1000

## Accessory Drawers

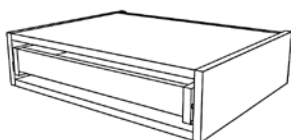

VANITY DRAWER  
120 high, 115 drawer

Code: **BV5 - BV10**

Width (mm): 500 - 1000

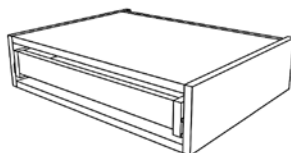

VANITY DRAWER  
145 high, 140 drawer

Code: **BV5B - BV10B**

Width (mm): 500 - 1000

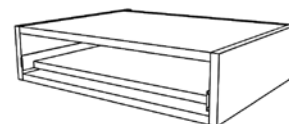

KEYBOARD DRAWER  
145 high

Code: **BK5 - BK8**

Width (mm): 500 - 800



## Accessory Panels



### ADDITIONAL SHELF

470 deep

Code: **BS3 - BS10**

Width (mm): 300 - 1000



### CEILING SCRIBING PANEL

Code: **BSP2 - BSP10**

Width (mm): 2600 x 200 - 1000



### MFC PLINTH

Code: **BBPMFC**

Width (mm): 2600 x 100



### BRIDGING SCRIBE PANEL

Edged two long sides

Code: **BBSP**

Width (mm): 2600 x 570



### FLYOVER SHELF

2600 long

Code: **BFO15 - BFO45**

Width (mm): 150 - 450



### SHOWBACK PANEL

900 high

Code: **BBP12 - BBP26**

Width (mm): 1200 - 1600



### END SUPPORT PANEL

600 wide

Code: **BBEPS - XTEP**

Height (mm): 640 - 2400



### BASE & WALL FILLER

100 wide

Code: **BF2 - BF7**

Height (mm): 720 - 2600



### BASE & WALL FILLER

200 wide

Code: **BF9 - BF14**

Height (mm): 720 - 2600

# 10 year Carcass Guarantee

**This guarantee does not apply to any parts, materials or equipment that are not supplied by Back to Basics Ltd t/a Basically Trade, nor does it apply to faults arising from incorrect design, poor planning, substandard fitting, insufficient maintenance or damage caused by water ingress.**

We, Back to Basics Ltd t/a Basically Trade (The 'Seller') – Company Registration No 5504769, Unit 2, Wyre Street, Padiham, Lancashire, BB12 8DF hereby Guarantee that the Kitchen and Bedroom carcasses will be free from manufacturing defects in materials and workmanship for a period of 10 years from the date of delivery of the products, subject to the following conditions:

1. In so far as the terms of this Guarantee are inconsistent with the Seller's standard terms and conditions of sale, the contents of this Guarantee shall prevail.
2. Our Customer must notify the Seller, in writing, of the nature of the alleged defect within one month of the delivery date or (where the defect or failure was not apparent upon reasonable inspection) within 3 months after the date of discovery and within the period of this Guarantee.
3. The Seller shall not be liable for any defect on its products arising from any drawing, design or specification supplied by, or to our Customer.
4. The Seller shall not be liable for any defect arising from wilful damage, negligence, abnormal working conditions, incorrect design or fitting by our Customer or any third party other than the Seller. Neither will it be liable for our Customer's failure to follow the Seller's instructions (whether oral or in writing), misuse, alteration or repair of the products without the Seller's prior approval.
5. The Seller shall not be liable for normal product wear and tear as a result of general domestic use. Neither does this Guarantee apply to defects relating to other manufacturer's products.
6. The Seller shall not be liable under the Guarantee if the total price of the products has not been paid for by the due date for payment.
7. Where any valid claim regarding a product is agreed by the Seller and is based upon a defect in the quality or condition of the products or the Seller's failure to meet any specification, our Customer shall be entitled at their choice to have the original product repaired. If, from this, the claim cannot be resolved it will be directly replaced with the most similar product available at the time. No credit notes or cash refund will be given by the Seller; neither will it be responsible for the product installation.
8. Save for the Seller's obligations referred to in clause 7 above, the Seller shall have no further liability to our Customer and shall not be liable (save for death or personal injury) for consequential loss or damage, costs, expenses, or other claims for consequential compensation (whether caused by the negligence of the Seller, its employees, agents or otherwise) in connection with the supply of the products or their use or resale by our Customer.
9. Natural environmental changes, such as the passage of time and exposure to light, cause the colour of materials to gradually alter. Therefore if a replacement is required, it may not be possible to provide a new carcass which exactly matches the existing units. In this case, should the original material be no longer available, the Seller will endeavour to provide the closest possible alternative from the current range.
10. This Guarantee shall be governed by and construed in all respects in accordance with English Law.
11. This Guarantee is nontransferable and supersedes any previous agreement or contract, expressed or implied.
12. Your Statutory Rights are not affected by the Terms of this Guarantee.





**Basically Trade**

Unit 2  
Wyre Street  
Padiham  
Lancashire  
BB12 8DA

**01282 816434**

email: [sales@basicallytrade.co.uk](mailto:sales@basicallytrade.co.uk)

[www.basicallytrade.co.uk](http://www.basicallytrade.co.uk)



**basically trade**<sup>®</sup>

bespoke kitchens, bedrooms & doors